

# FESTA



## **Festa, where design becomes performance.**

Created to meet all the needs of the Horeca world, Festa is the machine that brings together high performance, exclusive design and excellent drinks in a simple, attractive and smart solution.



## The fully automatic dispenser designed by taste professionals for catering professionals.



Meeting the demands of versatility, drink quality, taste variety, ease of use and aesthetic appeal, this fully automatic dispenser is able to ensure an excellent relationship between investment and performance. Festa is beautiful to look at, easy to use, quick to clean and contains a fresh milk module, offering a complete menu with a variety of drinks for all tastes.

Accessories:

01 4-litre fridge module with cup holder to maintain the quality of fresh milk.

Cup warmer available as an option to ensure the correct cup temperature at all times.

|| DOUBLE OUTPUT TO DELIVER 2 CUPS OF COFFEE SIMULTANEOUSLY. || ILLUMINATED DELIVERY COMPARTMENT WITH TILTING CUP HOLDER, 170 MM IN HEIGHT TO USE ANY TYPE OF CUP, COMPATIBLE WITH A 130 MM JUG. || CUP HOLDER HEIGHT 135 MM  
|| LIQUID COLLECTION: 2L CAPACITY. || COFFEE GROUND COLLECTION: UP TO 40 COFFEE GROUNDS.



# Satisfy the most demanding customers with coffee and drinks for all tastes.

Espresso, double espresso, American coffee, long coffee in a big cup: coffee is not just about espresso, each consumer has a different habit. The coffee unit has a variable chamber, meaning that Festa can satisfy every consumer preference.

One blend of coffees, three instant products and a Fresh Milk Module for the preparation of excellent cappuccinos and many other easy-to-make recipes. The bartenders can therefore prepare a variety of perfect drinks without wasting energy, the roasters enhance the quality of its product, while coffee shops, catering and self-service areas meet the diverse needs of their international clientele.



|| VERSION WITH TRADITIONAL ESPRESSO GROUP AND VERSION WITH VARIABLE CHAMBER BREWER TO WORK WITH COFFEE DOSES OF 7 G TO 14 G AND TO SUPPLY ALL VARIETIES OF COFFEE: ESPRESSO, LONG, AMERICAN AND MANY MORE. || SYSTEM WITH VARIABLE BREWING PRESSURE: 1÷10 BARS. || HIGH-CAPACITY COFFEE HOPPER: 1.3 KG OF COFFEE.

## Simple, intuitive, touch screen.

The integrated 7" touch screen makes the consumer experience truly rewarding. Thanks to the clear and intuitive interface, one of the many drinks available is delivered instantly with just a touch. What's more, the user can specify the quantity of coffee, water or milk and create its favourite beverage in a simple step. Maximum functionality is not the only advantage. The screen has the ability to upload videos and images, meaning that it can be used both as an effective promotional tool and as a useful source of information.

|| INTUITIVE USER INTERFACE WITH 7" TOUCH SCREEN, THE IDEAL SOLUTION TO BROADCAST VIDEOS AND IMAGES.





## Design and functionality to best serve every environment.

Festa is the perfect combination of beauty, functionality and technology to fit into any restaurant space.

With the touch screen interface and high-quality materials, the Festa baristas can enhance their work and the self-service areas can offer users a great-tasting and easy to use consumer experience.

## Excellent performance for all types of usage frequency.

Festa can easily dispense up to 100 cups a day and, thanks to its modular smart electronic platform, its self-service mode ensures that the drinks are delivered safely and with maximum customisation.

Also designed to facilitate the work of baristas and service centres, Festa makes daily cleaning and maintenance quick and straightforward thanks to the easily accessible ground and liquid waste tray.



| Version                         | ESV  | ES                        |
|---------------------------------|--|---------------------------|
| Coffee group                    | Variable chamber (ESV)   | Traditional espresso (es) |
| Coffee bean container           | 1 x 1.3kg (3.5 L)  |                           |
| Single instant powder container | 3 (single coffee bean canister 1.3 L, dual coffee bean canister 3.5 L) |                           |
| Interface                       | Touch 7" customizable  |                           |
| Boiler resistance               | 2.80 kw double boiler  |                           |
| Power supply                    | 220/240 VAC, 50÷60 HZ  |                           |
| Water supply                    | 3/4" F   |                           |
| Dimensions mm                   | H 650 (720 with external coffee beans hopper) x W 395 x D 576          |                           |
| Weight                          | 31,5 kg  |                           |

#### Fresh Milk Module

|                       |   |
|-----------------------|---|
| Fresh Milk capacity   | 4 L   |
| Power supply          | 220-230 V 50 Hz<br>Specific national versions 220 V 60 Hz |
| Boiler resistance     | 0,043 kw  |
| Cooling unit          | Climate class N   |
| Refrigerant gas       | R600a   |
| Dimensions and weight | H 635 x W 300 x D 447 - 22 kg                             |

1. Coffee Beans 2. Chocolate  
3. Milk 4. instant

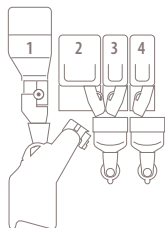

ESPRESSO





DESIGN  
YOUR BREAK